

## PRODUCT DESCRIPTION

Battery Backup Driver included to convert for Emergency Lighting - 90+ Minutes on the battery to meet Emergency Lighting Standards. This wall pack comes with Photocell (Dusk to Dawn), option without Photocell is available.



DLC #: RGL-DURADO-4-TT-150WBSGDA1

## PRODUCT FEATURES & COMMON USE APPLICATIONS

- UL cUL certificate.
- Lumileds 2835, high CRI.
- Input voltage 120-277VAC .
- Output constant current lever can be adjusted through output cable with 0-10V.
- Wattage abjustable.
- No UV or IR in the beam.
- Easy to install and operate.
- Energy saving, long lifespan.
- Light is soft and uniform, safe to eyes.
- Instant start, NO flickering, NO humming.
- Green and eco-friendly without mercury
- Entrance lighting,courtyard lighting;
- Industrial lighting,Outdoor landscape lighting;
- Building,The hotel;
- Wall lighting area and so on.

## PRODUCT DIMENSIONS

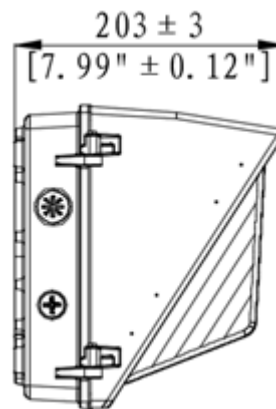
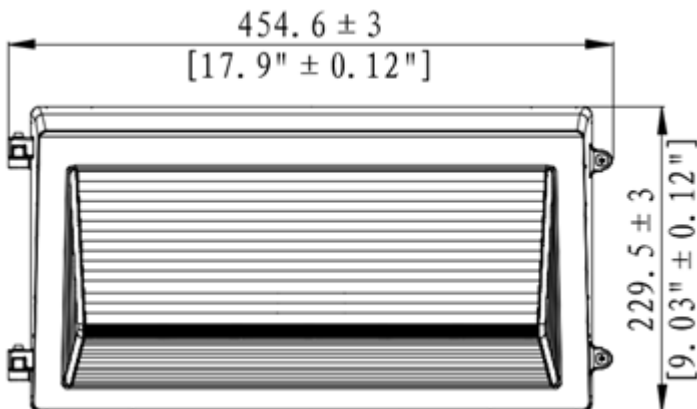

### LEGENDARY USA SUPPORT



US based phone and online customer support

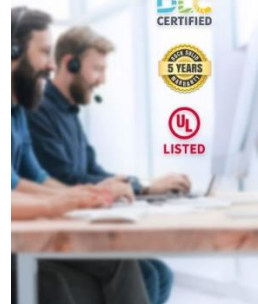



## PRODUCT TECHNICAL SPECIFICATIONS

|                   |                                     |                                                               |         |         |
|-------------------|-------------------------------------|---------------------------------------------------------------|---------|---------|
| <b>OPTICAL</b>    | Input Power (Tolerance : ±10%)      | 150W/120W/100W                                                |         |         |
|                   | Color Temperature(Color tunable)    | 3000K                                                         | 4000K   | 5000K   |
|                   | Lumen (Tolerance : ±10%)            | 20859LM                                                       | 22396LM | 21011LM |
|                   | Efficacy (Tolerance : ±3%)          | 135LM/W                                                       | 150LM/W | 143LM/W |
|                   | CRI                                 | >80                                                           |         |         |
|                   | Color Consistency                   | <7 Steps (or <7 SDCM)                                         |         |         |
|                   | BUG                                 | B3-U5-G5                                                      |         |         |
|                   | Diffuser Type                       | Stripe Glass                                                  |         |         |
|                   | Beam Angle (50%) (Tolerance : ±15%) | H91*V98                                                       |         |         |
| <b>ELECTRICAL</b> | Input Voltage and Frequency         | 120-277VAC 50/60Hz                                            |         |         |
|                   | PF (Tolerance : -3%)                | ≥0.9                                                          |         |         |
|                   | THD (Tolerance : +5%)               | ≤20%                                                          |         |         |
|                   | Flicker Percent                     | <5%                                                           |         |         |
|                   | Driver Brand                        | SOSEN                                                         |         |         |
|                   | Driver Model                        | SS-160NH-E260BHP/SS-160NH-E260BHBP                            |         |         |
|                   | Driver Surge protection             | L-N: 6kV , L&N-E:6kV                                          |         |         |
|                   | Dimming                             | 0-10V dimming standard                                        |         |         |
|                   | Sensor Type                         | Occupancy Sensor                                              |         |         |
|                   | Optional Accessory                  | Surge-protective Device, Motion Sensor, PIR Sensor, emergency |         |         |
| <b>MATERIALS</b>  | LED Brand                           | LUMILEDS                                                      |         |         |
|                   | LED Type                            | SMD 2835                                                      |         |         |
|                   | LED QTY                             | 364*2 PCS                                                     |         |         |
|                   | Housing                             | Die-cast aluminum                                             |         |         |
|                   | Housing Color                       | All Color                                                     |         |         |
|                   | Waterproof Rating                   | WET (IP65)                                                    |         |         |
| <b>OTHERS</b>     | Operating Temperature               | -40°C TO 50°C; Sensor:-25°C TO 50°C; emergency:0°C TO 50°C    |         |         |
|                   | Storage Temperature                 | -40°C TO 80°C                                                 |         |         |
|                   | Operating Humidity                  | 20% - 90% RH                                                  |         |         |
|                   | Storage Humidity                    | 10% - 95% RH                                                  |         |         |
|                   | Warranty                            | 5 years warranty                                              |         |         |

## PRODUCT MOUNTS & ACCESSORIES



## PRODUCT IMAGES & ACTUAL INSTALLATIONS

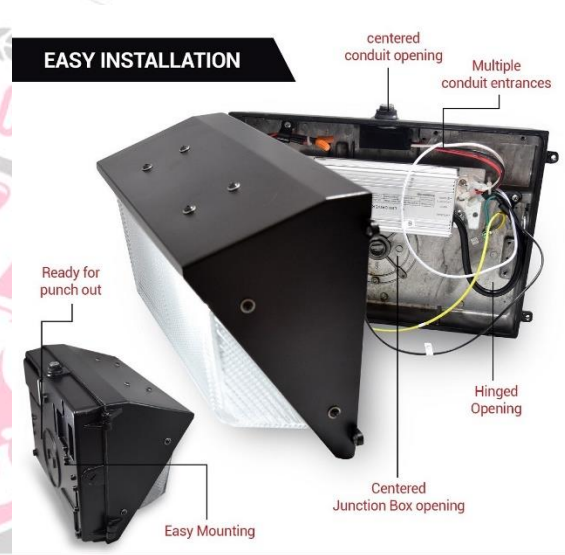
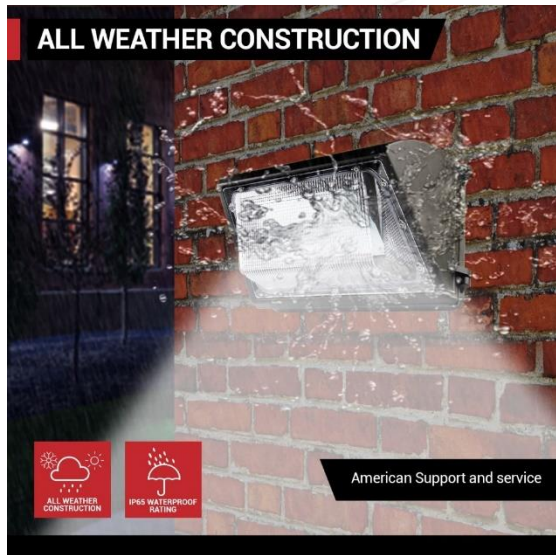

## PHOTOMETRICS

### Luminaire Property

Luminaire Manufacturer:  
 Luminaire Category:  
 Lamp Catalog:  
 Number of Lamps:  
 Luminous Length (mm):  
 Luminous Height (mm):  
 Current: 1.283 A  
 Power Factor: 0.999

Luminaire Description:  
 Lamp Description:  
 Lumens per Lamp:  
 Luminous Width (mm):  
 Voltage: 120.0 V  
 Power: 153.85 W

### Photometric Results

IES Classification: Type IV  
 Total Rated Lamp Lumens: 20859.0 lm  
 Efficiency: 100%  
 Upward Ratio: 11%  
 C0r0 Intensity: 6770.81 cd  
 Pos of Max. Intensity: H90 V45  
 Beam Angle(C0/C180,C90/C270,C45/C225,C135/315): 91.8, 98.8, 97.7, 97.5

Longitudinal Classification: Very Short  
 Measurement Flux: 20859 lm  
 Downward Ratio: 89%  
 Luminaire Efficacy Rating (LER): 135.63  
 Max. Intensity: 8422.54 cd

Luminous Intensity Distribution Curve

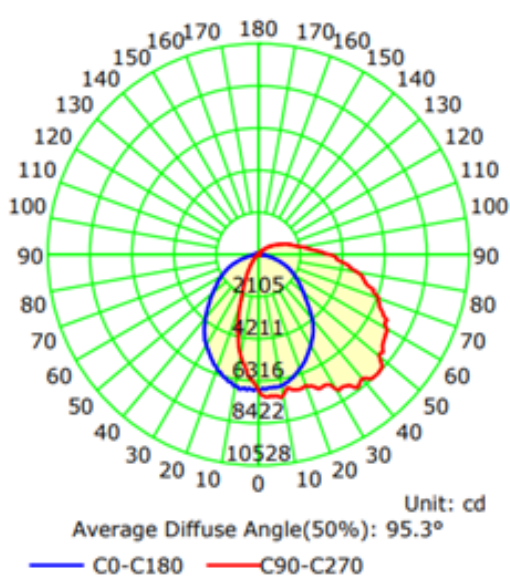

The Average Illuminance Effective Figure

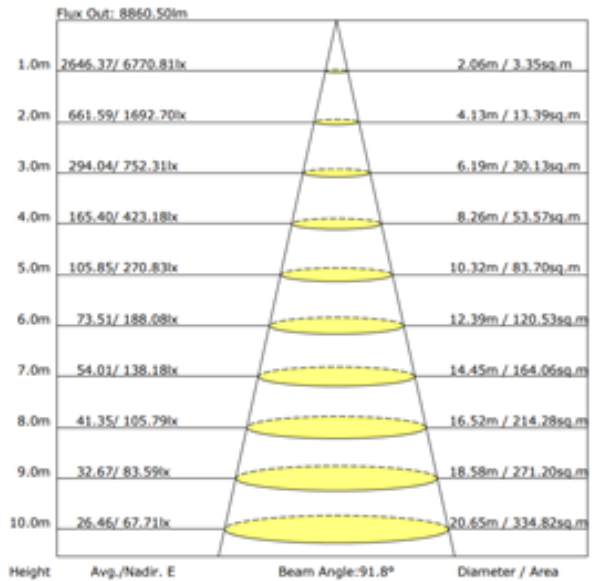

## DLC PRODUCT SPEC

Product ID: S-F8J2TL

X



### RGL-DURADO-4-TT-150WBSGDA1-abcW30/40/50

Manufacturer: RuggedGrade  
Brand: RuggedGrade

#### PRODUCT OVERVIEW

|                        |                                                                 |
|------------------------|-----------------------------------------------------------------|
| Model Number           | RGL DURADO-4 TT-150WBSGDA1-abcW30/40/50                         |
| Classification         | Premium                                                         |
| Primary Use            | Outdoor Non-Cutoff and Semi-Cutoff Wall Mounted Area Luminaires |
| Reported Input Wattage | 153.9 W                                                         |
| Reported Light Output  | 20859 lm                                                        |
| Reported CCT           | 3000 K                                                          |
| Reported CRI (Ra)      | 82                                                              |
| Product ID             | S-F8J2TL                                                        |
| DLC Family Code        | BCBAEZ                                                          |
| Listing Status         | Listed                                                          |
| Date Qualified         | 2024-05-16                                                      |

#### PRODUCT INFORMATION

|                                |                                         |
|--------------------------------|-----------------------------------------|
| Qualified Product List         | Solid State Lighting                    |
| Technical Requirements Version | 5.1                                     |
| Product ID                     | S-F8J2TL                                |
| Manufacturer                   | RuggedGrade                             |
| Brand                          | RuggedGrade                             |
| Model Number                   | RGL DURADO-4 TT-150WBSGDA1-abcW30/40/50 |
| Parent                         | No                                      |
| Classification                 | Premium                                 |

#### PRODUCT CATEGORIZATION

[VIEW DETAILS](#)

#### CONTROL FEATURES

[VIEW DETAILS](#)

#### REPORTED PHOTOMETRIC PERFORMANCE

|                        |             |
|------------------------|-------------|
| Reported Light Output  | 20859 lm    |
| Reported Efficacy (AC) | 135.58 lm/W |
| Reported CCT           | 3000 K      |
| Reported CRI (Ra)      | 82          |
| Reported R9            | 4           |
| Reported IES Rf        | 84          |
| Reported IES Rg        | 96          |
| Reported IES Rcs,h1    | 12          |

#### REPORTED ELECTRICAL PERFORMANCE

|                                    |           |
|------------------------------------|-----------|
| Reported Input Wattage             | 153.9 W   |
| Reported Total Harmonic Distortion | 15 %      |
| Reported Power Factor              | 0.9       |
| Reported Minimum Input Wattage     | 37.5 W    |
| Reported Maximum Input Wattage     | 153.9     |
| Reported Default Input Wattage     | 153.9 W   |
| Voltage Range                      | 120-277 V |



## PRODUCT PACKAGING

|           | Size                                 | Qty / Carton | Net Weight / Carton | Gross Weight / Carton |
|-----------|--------------------------------------|--------------|---------------------|-----------------------|
| Outer box | 487*277*260mm<br>(19.2"*10.9"*10.2") | 1 PCS        | 5.3KG<br>(11.6lb)   | 6.4KG<br>(14.2lb)     |

Tolerance of Carton Size: ±15 MM, Tolerance of Weight: ±10%.

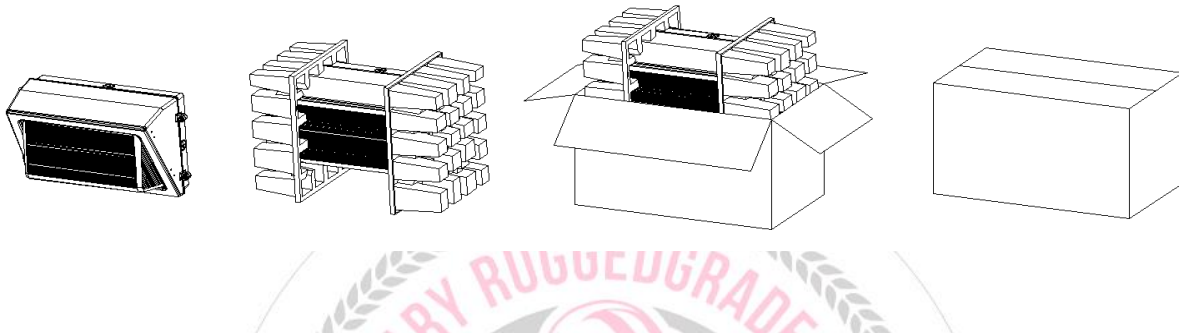

## PRODUCT WARNINGS

- ⚠ Please turn off power before install or change assembly parts.
- ⚠ The input voltage and lamps should be matched, after connecting the power line.
- ⚠ Please make sure the wiring section is insulated.
- ⚠ Professionals must install and disassemble the lamps.
- ⚠ Surge is the number 1 cause of LED light failure. Outdoor lights must have surge at fixture, pole, and breaker.
- ⚠ Surge is the number 1 cause of LED light failure. Indoor lights must have surge at fixture and breaker.

## PRODUCT TROUBLESHOOTING

| Issue                       | Check points                                                                                                                                                                                                                                                                                                                                                                                                                                                                                       |
|-----------------------------|----------------------------------------------------------------------------------------------------------------------------------------------------------------------------------------------------------------------------------------------------------------------------------------------------------------------------------------------------------------------------------------------------------------------------------------------------------------------------------------------------|
| Light Flickers              | Check all wiring for disconnections, shorts and burnt wiring and connections. Confirm steady input voltage to the light fixture, fluctuating input voltage will harm the LED driver and can lead to premature failure. Lights with photocells can have photocell tag from ambient light or light reflecting at the sensor. Simply cover the photocell completely and see if flickering continues while the photocell is covered. Call Tech Support for help if none of the above solves the issue. |
| Light does not work at all. | Check all wiring for disconnections, shorts and burnt wiring and connections. Confirm steady input voltage to the light fixture, fluctuating input voltage will harm the LED driver and can lead to premature failure. If input voltage is not in the voltage range of the fixture, you will need to find the source of your input voltage issue. Call Tech Support for help if none of the above solves the issue.                                                                                |

For more technical information, install questions, troubleshooting help or warranty claims, we have a dedicated US Tech and Customer Support Team to help solve any issues you have and can be reached by email or phone. If you need help with any of our products, we are here for you so that you are never in the dark!

# BETTER LIGHTS. BETTER SUPPORT.

