

PRODUCT DESCRIPTION

THE NEW STREET LIGHT IS A NEW PRIVATE DESIGN LED SOLAR STREET LIGHT, WITH A SLIM DESIGN AND A HIGHER CONVERSION EFFICIENCY. MONO-CRYSTALLINE PHOTOVOLTAIC SOLAR PANEL THAT CAUSE A 230LM/W EFFICIENCY ALLOWS US TO MEET NEW AND BETTER STANDARDS.



Part #: RGL-VAYDA-40W

PRODUCT FEATURES & COMMON USE APPLICATIONS

- ✓ Nice design with lighter weight, easier installation
- ✓ Shatterproof Rating: IK08
- ✓ The controller has dimming and timer options
- ✓ Battery life is longer with an 6-7 hour charge
- ✓ Easy to install and operate
- ✓ Energy saving, long lifespan
- ✓ Instant start, NO flickering, NO humming
- ✓ Green and eco-friendly without mercury
- ✓ Adjustable Beam Angle
- ✓ Street Lighting
- ✓ Outdoor landscaping light
- ✓ Building, The Hotel.
- ✓ Parking Lot

PRODUCT DIMENSIONS

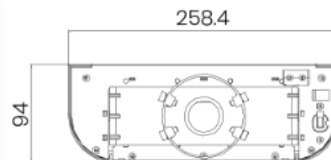
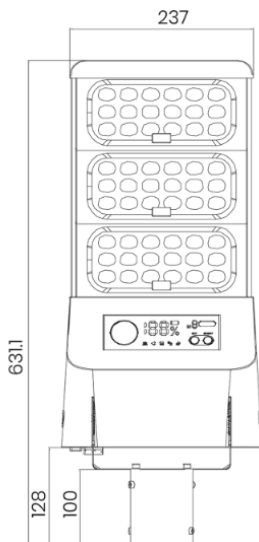

Rugged Grade Lighting
Industrial Grade Solutions



LEGENDARY USA SUPPORT



US based
phone and online
customer support

DLC
CERTIFIED

5 YEARS
WARRANTY

UL
LISTED

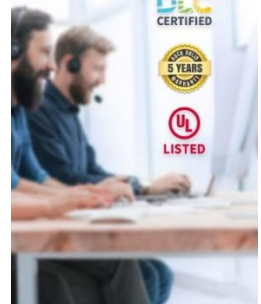

888-953-2476
sales@ruggedgrade.com

PRODUCT TECHNICAL SPECIFICATIONS

OPTICAL	Input Power (Tolerance: ±10%)	40W
	Color Temperature	3000K/5700K
	Efficacy (Tolerance: -3%)	230 LM/W
	Lumens	9000LM
	Solar Panel Specs	Monocrystalline silicon 13.2V/ 20W
	Charging / Discharging Temp	-10°C~55°C / -20°C~60°C
	Light Distribution	Type IV
	Battery Capacity	11.1V, 115.44WH
	Charge Time	6.86 Hours
	LED Screen Content	Battery capacity displayed from 0 to 100%, after the screen light up for 30s (Low battery icon will illuminate when the battery capacity drops below 20%)
ELECTRICAL	Lighting Mode Display	Always show the lighting mode (but will not display when screen off)
	Control Mode	Button Switch, ON/OFF Long Press 1.5s
	Lighting Mode	M1: 30% (PIR 30S) Till dawn M2: 30% (PIR 30S) 5H + 20% (PIR 30S) Till dawn M3: 30% (PIR 30S) 6H + 10% 5H + 30% (PIR 30S) Till dawn
	Core technology	ALS2.4
	External device identification	Identify external device connection automatically: solar panels, adapters, backup batteries
	Motion Sensor (PIR)	120°, 8m.Max
	Net Weight	3.37kg
	LED Brand	OSRAM
	LED Type	SMD3030
MATERIALS	LED QTY	108 PCS
	Housing	Aluminum Alloy+PC
	Housing Color	Black
	IP / IK Class	IP65 / IK08
	Operating Temperature	-10°C ~ 55°C
	Storage Temperature	-10°C ~ 55°C
	Operating Humidity	20% - 90% RH
OTHERS	Storage Humidity	10% - 95% RH
	Warranty	3 years warranty
	Install Height	5M

PRODUCT ACCESORIES



PHOTOMETRICS

Type-4 lighting distribution

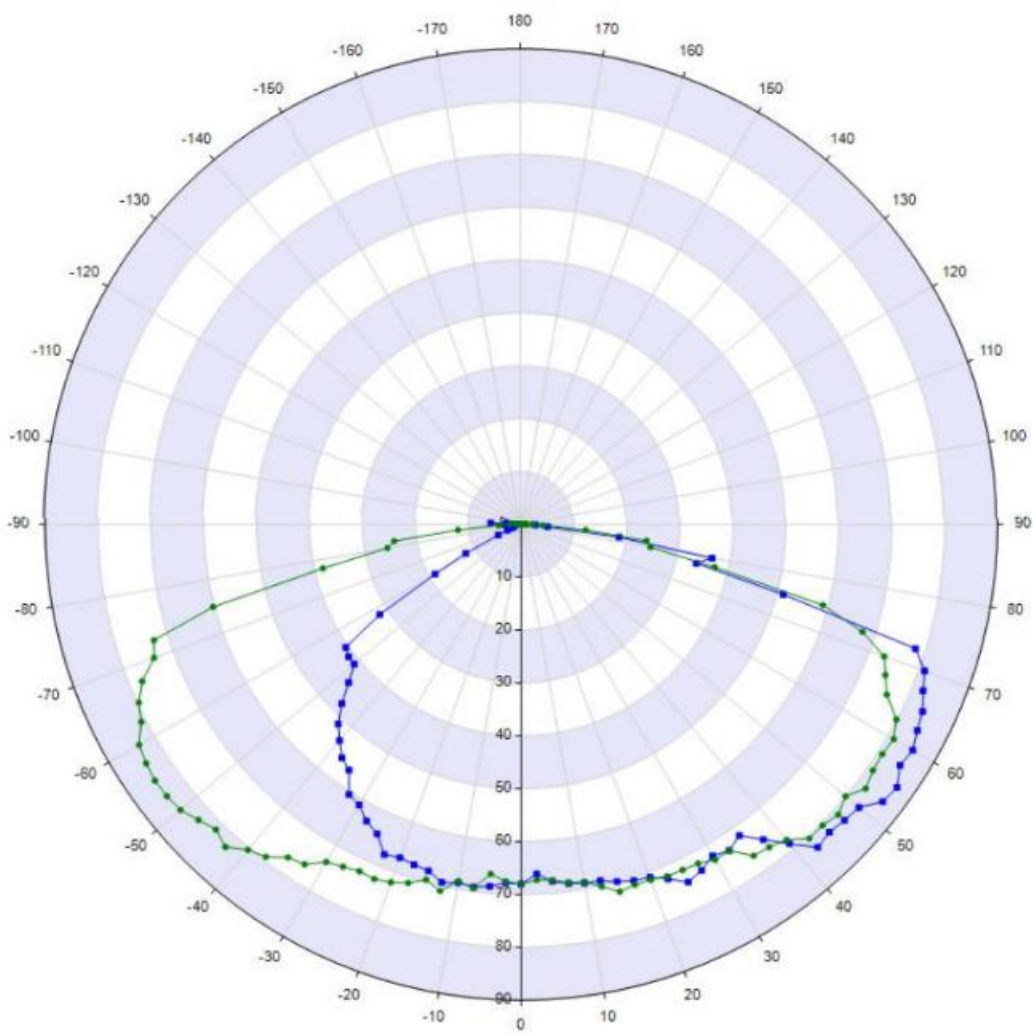

PRODUCT FEATURES

Monocrystalline
Solar Charging Efficiency: >21%



High Lumen LEDs 230lm/W



Program Writer Port

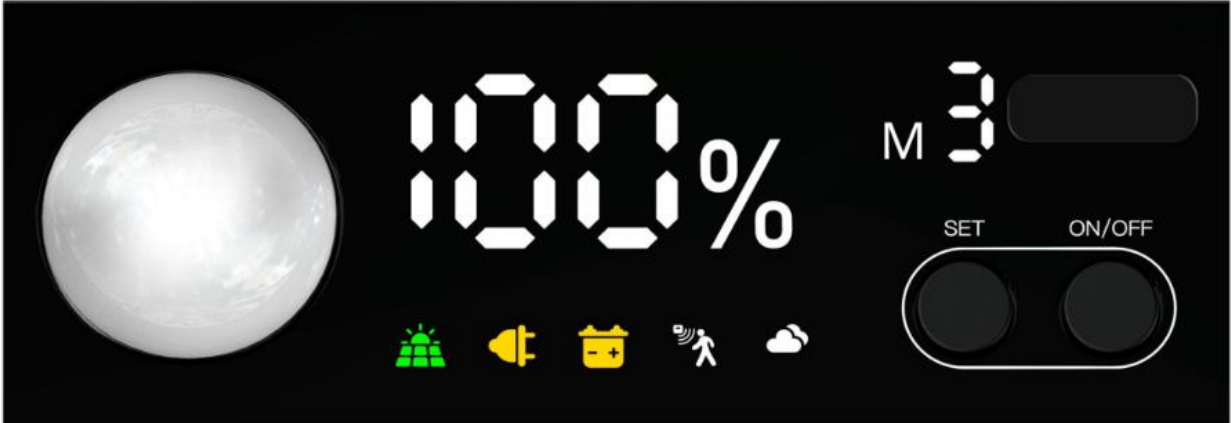

Extension Port



Rain sensor

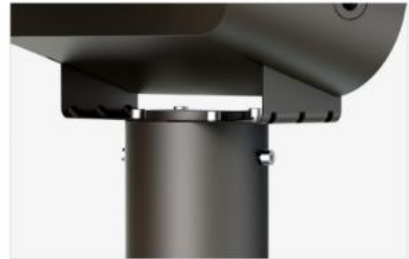

Adjustable Angle Bracket

Extension Port

Support expansion parts: solar panel, backup battery, external adapters. Provide multiple solutions for different requirements.

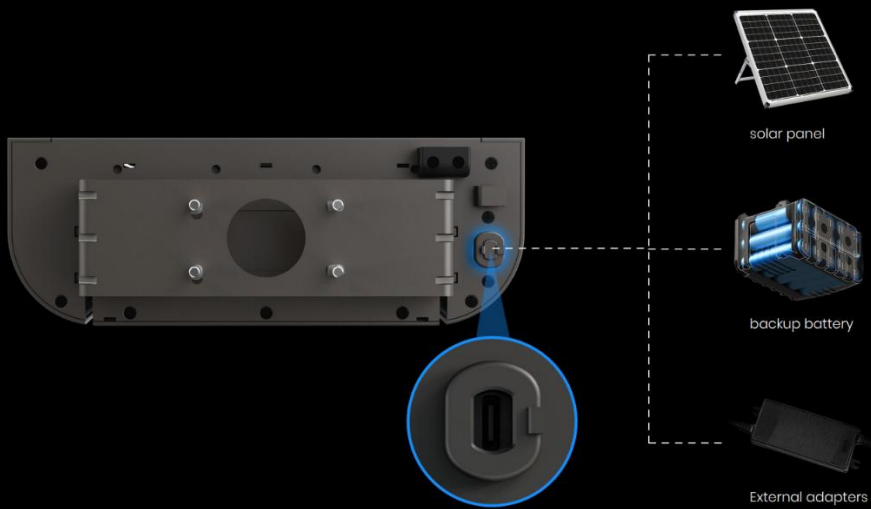

PRODUCT FEATURES

LED Screen

All functions are displayed with visual icons.

100% Remaining battery capacity

M 3 Mode

Solar

Adaptor

Back-up batteries

PIR

Rain sensor



Bil CCT, switchable by Rain Sensor

White LED color in normal weather and switch to warm led automatically when detect rainy days, to improve visibility.



MAIN FEATURES



INSTALLATION NOTES

1 Horizontal pole mounting



2 Vertical pole mounting

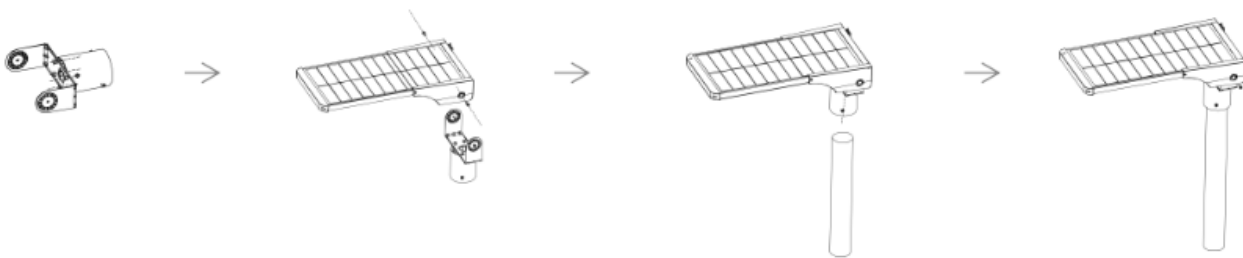

3 Wall mounting

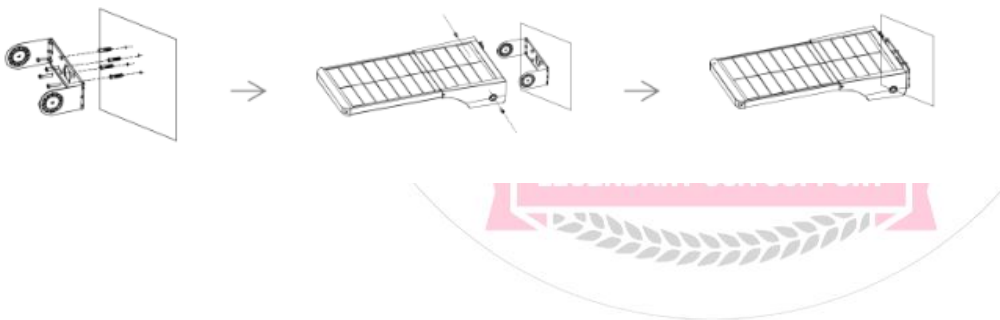

PRODUCT PACKAGING

PRODUCT LIST
 SOLAR LIGHT: 1 PC
 BRACKET: 1 PC
 REMOTE CONTROL: 1 PC

1 PC / 1 BOX

8 PCS / CARTON

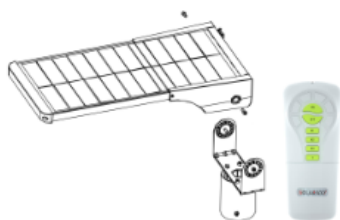

PRODUCT LIST



INNER BOX



CARTON

STEP 1

STEP 2

STEP 3

MODEL NO.	PACKING METHOD	PCS/CTN	QTY (PCS)	CTN QTY	CARTON SIZE(MM)	N.W.(KG)	G.W.(KG)
SSL-53	INNER BOX	1	1	1	262x113x332	/	/
	CARTON	8	8	1	544x472x352	/	/
SSL-56	INNER BOX	1	1	1	262x113x457	/	/
	CARTON	8	8	1	544x472x477	/	/
SSL-59	INNER BOX	1	1	1	262x113x552	/	/
	CARTON	8	8	1	544x472x572	/	/

Net weight and gross weight are for reference only



PRODUCT WARNINGS

- ⚡ Please turn off power before install or change assembly parts.
- ⚡ The input voltage and lamps should be matched, after connecting the power line.
- ⚡ Please make sure the wiring section is insulated.
- ⚡ Professionals must install and disassemble the lamps.
- ⚡ Surge is the number 1 cause of LED light failure. Outdoor lights must have surge at fixture, pole, and breaker.
- ⚡ Surge is the number 1 cause of LED light failure. Indoor lights must have surge at fixture and breaker.

PRODUCT TROUBLESHOOTING

Issue	Check points
Light Flickers	Check all wiring for disconnections, shorts and burnt wiring and connections. Confirm steady input voltage to the light fixture, fluctuating input voltage will harm the LED driver and can lead to premature failure. Lights with photocells can have photocell tag from ambient light or light reflecting at the sensor. Simply cover the photocell completely and see if flickering continues while the photocell is covered. Call Tech Support for help if none of the above solves the issue.
Light does not work at all.	Check all wiring for disconnections, shorts and burnt wiring and connections. Confirm steady input voltage to the light fixture, fluctuating input voltage will harm the LED driver and can lead to premature failure. If input voltage is not in the voltage range of the fixture, you will need to find the source of your input voltage issue. Call Tech Support for help if none of the above solves the issue.

For more technical information, install questions, troubleshooting help or warranty claims, we have a dedicated US Tech and Customer Support Team to help solve any issues you have and can be reached by email or phone. If you need help with any of our products, we are here for you so that you are never in the dark!

BETTER LIGHTS. BETTER SUPPORT.

