

## PRODUCT DESCRIPTION

The Vela III Series LED Grow Light is a high-performance horticultural lighting solution designed for optimal plant growth. Featuring Full Spectrum/Greenhouse Spectrum/Indoor Spectrum, it supports the cultivation of fruits, vegetables, and cannabis.



Part #: RGL-VELA-III-720W

## PRODUCT FEATURES & LOCATIONS

- UL cUL certificate.
  - Input voltage 120-277VAC.
  - No UV or IR in the beam.
  - Easy to install and operate.
  - Energy saving, long lifespan.
  - Light is soft and uniform, safe to eyes.
  - Instant start, NO flickering, NO humming.
  - Green and eco-friendly without mercury.
- Green Houses
  - Small Gardens
  - Large Farming Operation

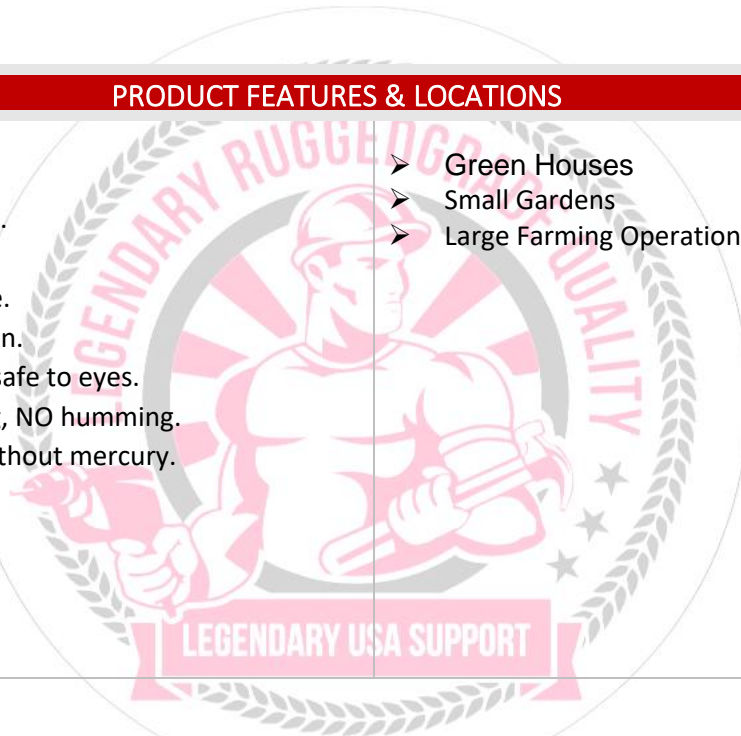

## PRODUCT DIMENSIONS

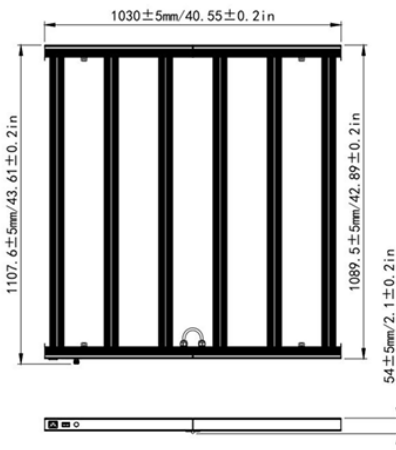

Unfold

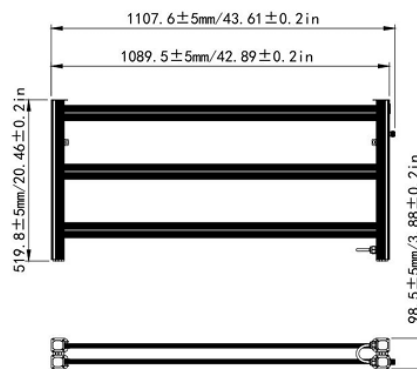

fold

Rugged Grade Lighting  
Industrial Grade Solutions



## LEGENDARY USA SUPPORT







888-953-2476  
sales@ruggedgrade.com

## PRODUCT TECHNICAL SPECIFICATIONS

<b>OPTICAL</b>	Input Power (Tolerance : ±10%)	720W
	Photosynthetic photon flux (Tolerance : ±10%)	1870 μmols
	Luminous Efficacy(Tolerance : -5%)	2.6μmol/J
	Viewing Angle (Tolerance : ±10%)	115°
	Spectrum	Full Spectrum/Greenhouse Spectrum/Indoor Spectrum
	CRI	>80
<b>ELECTRICAL</b>	Input Voltage and Frequency	120-347VAC, 50/60Hz
	PF (Tolerance : -3%)	≥0.9
	THD (Tolerance : +5%)	≤20%
	BTU	2456 BTUs
	Dimming	0-10V
	Driver Surge protection	L/N-PE: 6kV, L-N: 6kV
	Driver Brand	Rugged Grade Lighting
	Driver Model	RG-720W-120-270VAC
	Housing	Extrusion Aluminum Alloy
	Housing Color	Silver
	Waterproof Rating	DAMP(IP20)
<b>MATERIALS</b>	Operating Temperature	-18°C TO 50°C
	Storage Temperature	-40°C TO 80°C
	Storage Humidity	10%-95% RH
	Operating Humidity	20%-90% RH
	Warranty	5 years warranty with 24/7 operating hours Luminaire lifetime at 25°C.

## PRODUCT MOUNTS & ACCESSORIES

 <p>Supply cable X1</p> <p>3*0.75MM², 300/500V, -40°C-105°C, L=1.4meters</p>	 <p>Dimming wire x1</p> <p>Length: 3 meters, RJ12, 6P4C</p>
 <p>Rope Ratchet x2</p> <p>1/8 Lifting Pulley Rope Hook Nylon rope length: 1.8 meters</p>	 <p>Steel wire rope x2</p> <p>Wire diameter: Φ1.5mm, Stainless steel SUS304 Main wire length: 50MM, Two branch wires length: 400MM The main wire end is fitted with a 40mm closed loop made of steel wire rope</p>



## PHOTOMETRICS

### LIGHT DISTRIBUTION TESTING PARAMETERS

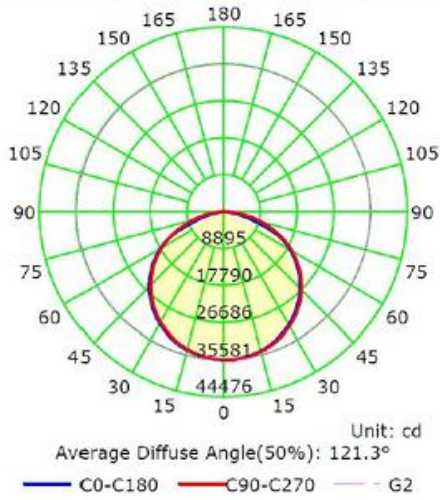

### LIGHT SPECTRUM

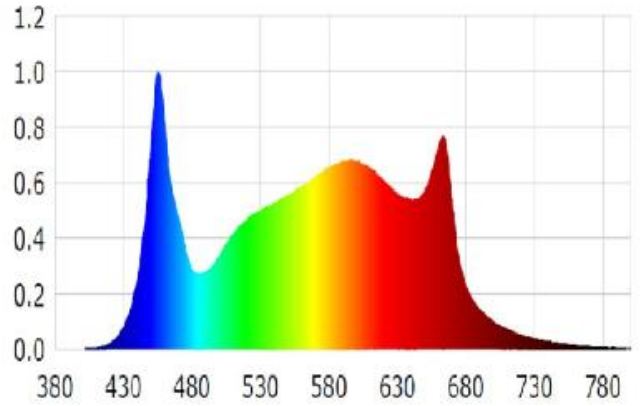

### PPFD READING(test height 1ft)

	24"	18"	12"	6"	0	6"	12"	18"	24"
24"	199		367		423		370		203
18"		624			829			630	
12"	529		1126		1222		1131		533
6"				1361	1376	1356			
0	617	1095	1334	1412	1428	1407	13221	1072	613
6"				1368	1385	1360			
12"	536		1139		1235		1125		528
18"		630			828			625	
24"	200		384		418		363		196



## PRODUCT PACKAGING

Net Weight / Carton	Gross Weight / Carton	Qty / Carton	Carton Size
5.95kg	9.72kg	1 pc	1170mm*575mm*132mm

Tolerance of Carton Size:  $\pm 15$  mm [ $\pm 0.59$  inch], Tolerance of Weight:  $\pm 10\%$ .

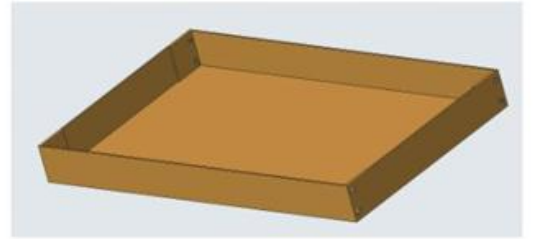
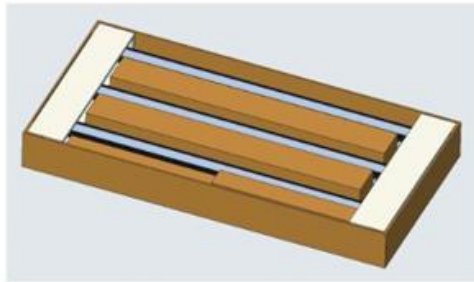
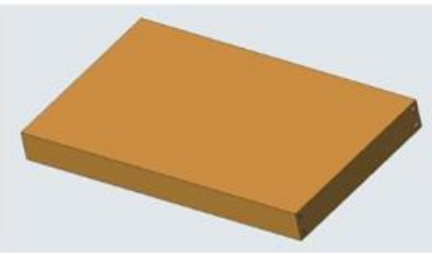

## PRODUCT WARNINGS

- ⚠ Please turn off power before install or change assembly parts.
- ⚠ The input voltage and lamps should be matched, after connecting the power line.
- ⚠ Please make sure the wiring section is insulated.
- ⚠ Professionals must install and disassemble the lamps.
- ⚠ Surge is the number 1 cause of LED light failure. Outdoor lights must have surge at fixture, pole, and breaker.
- ⚠ Surge is the number 1 cause of LED light failure. Indoor lights must have surge at fixture and breaker.

## PRODUCT TROUBLESHOOTING

Issue	Check points
Light Flickers	Check all wiring for disconnections, shorts and burnt wiring and connections. Confirm steady input voltage to the light fixture, fluctuating input voltage will harm the LED driver and can lead to premature failure. Lights with photocells can have photocell tag from ambient light or light reflecting at the sensor. Simply cover the photocell completely and see if flickering continues while the photocell is covered. Call Tech Support for help if none of the above solves the issue.
Light does not work at all.	Check all wiring for disconnections, shorts and burnt wiring and connections. Confirm steady input voltage to the light fixture, fluctuating input voltage will harm the LED driver and can lead to premature failure. If input voltage is not in the voltage range of the fixture, you will need to find the source of your input voltage issue. Call Tech Support for help if none of the above solves the issue.

For more technical information, install questions, troubleshooting help or warranty claims, we have a dedicated US Tech and Customer Support Team to help solve any issues you have and can be reached by email or phone. If you need help with any of our products, we are here for you so that you are never in the dark!

# BETTER LIGHTS. BETTER SUPPORT.

