

PRODUCT DESCRIPTION

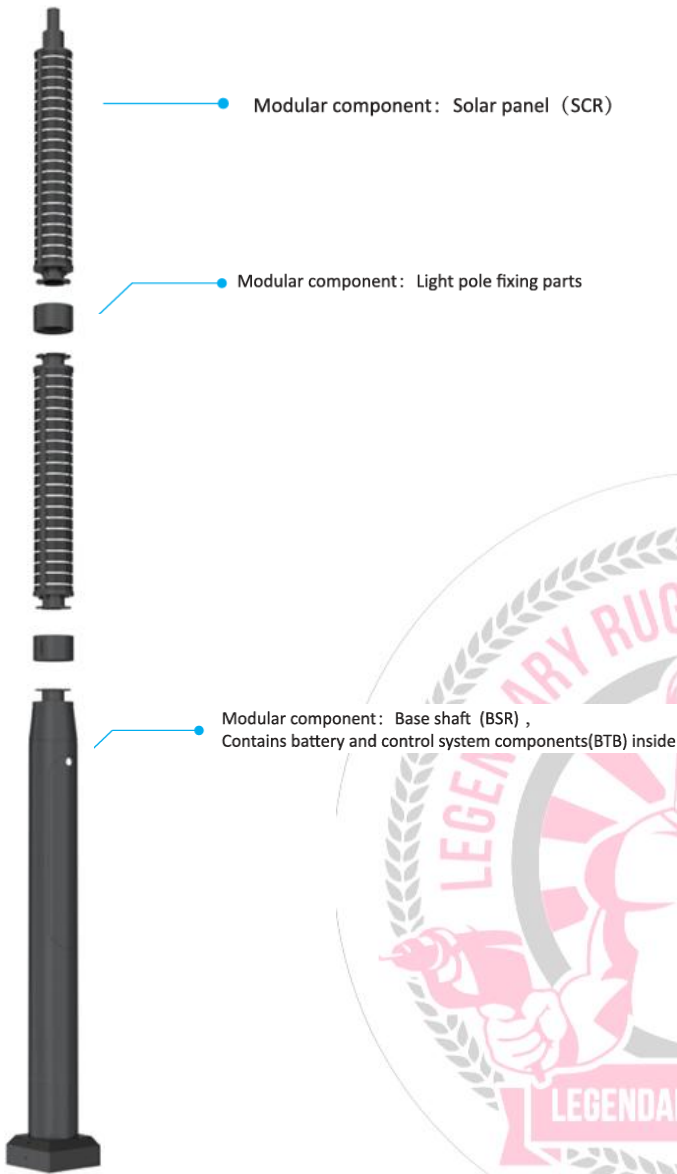

The new Solar Light Pole is engineered for modern cityscapes, parks, and public squares, combining a modular pole architecture with integrated solar generation and energy storage to deliver autonomous, low-voltage lighting without trenching or external wiring.

KEY FEATURES

- **360° high-efficiency solar panel wrap** — the pole is wrapped with solar panels that capture sunlight from all directions, increasing daily energy harvest and enabling vertical installation that promotes self-cleaning and easier maintenance.
- **Modular component design** — each functional module (lighting head, battery pack, controller, panel sections) is individually packed for lower transport cost and quick on-site assembly, maintenance, and replacement, reducing downtime and lifecycle service costs.
- **MPPT solar charge controller** — maximizes energy extraction from the panels under varying irradiance, improving charging efficiency and battery life compared with simpler controllers.
- **UL-certified key materials** — critical components meet UL certification standards, supporting safety and regulatory acceptance in many markets.

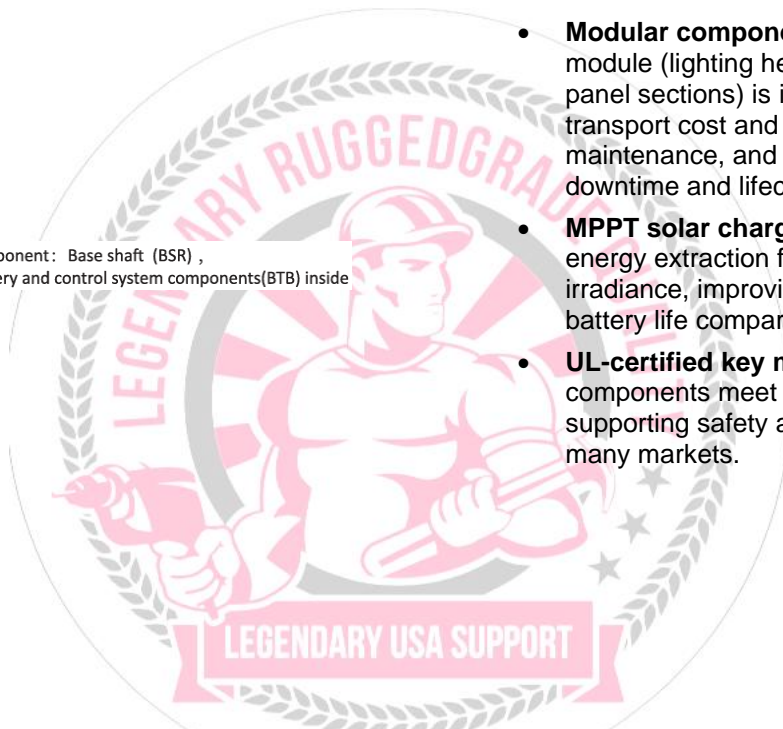

POLE BASE DIMENSIONS

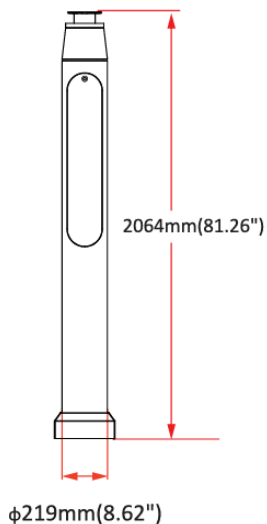

POLE/PANEL DIMENSIONS

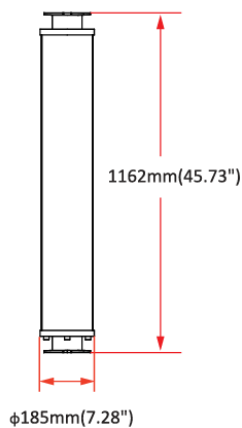

ADAPTER DIMENSIONS

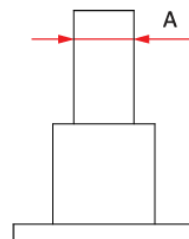

The diameter of the standard adapter is $\phi 76\text{mm} (3.0")$;
The diameter can be customized according to customer needs



LEGENDARY USA SUPPORT



US based
phone and online
customer support

DIC
CERTIFIED

5 YEARS
WARRANTY

UL
LISTED

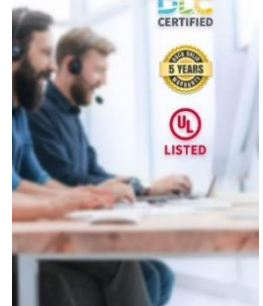

PRODUCT TECHNICAL SPECIFICATIONS

SOLAR POLE BASE	Input Power (Tolerance: $\pm 10\%$)	100W
	Battery Capacity	1114WH
	Operating Voltage	12.8V
	Charging Time	4-10Hr
	Output Voltage	20-35V
	Solar Pole Size	219mm (8.62")
	Solar Pole Height	2064mm (81.26")
	Solar Pole Wall Thickness	2.5mm (0.1")
	Solar Pole Flange Dimensions (AxBxCxDxE)	279x279x221x21x19mm (11"x11"x8.7"x0.83"x3/4")
	Solar Pole Anchor Bolt Kit Dimensions (AxBxCxDxE)	19x64x90x150mm (3/4"x25.39"x3.54"x5.91")
SOLAR PANEL/POLE SECTION	Solar Pole Weight	51 Kg
	Solar Panel Wattage	100W
	Solar Panel Volts	22V
	Solar Panel Size	185mm (7.28")
	Solar Panel Height	1161mm (45.73")
	Solar Panel Wall Thickness	3mm (.12")
	Solar Panel Weight	15 Kg
	Warranty	5-Year
Battery Life	Time Control Mode: Night Owl (30Hrs)/ Early Bird(28Hrs) Constant Mode: 100%(17Hrs)/ 70%(22Hrs)/ 40%(33Hrs)	

PRODUCT ACCESORIES DIMENSIONS

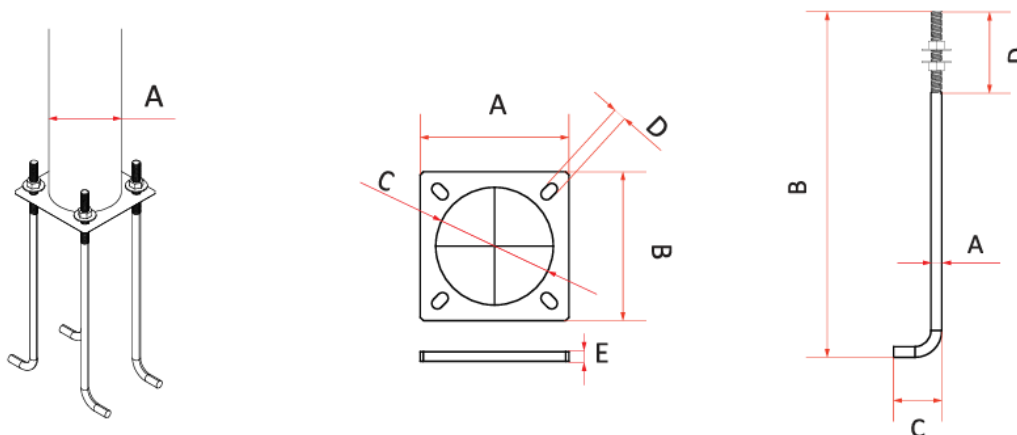

Flange Dimension AxBxCxDxE	Anchor bolt kit AxBxCxD
279x279x221x21x19mm (11"x11"x8.7"x0.83"x3/4")	19x64x90x150 (3/4"x25.39"x3.54"x5.91")



INSTALLATION INSTRUCTIONS

Fixing between splicing poles

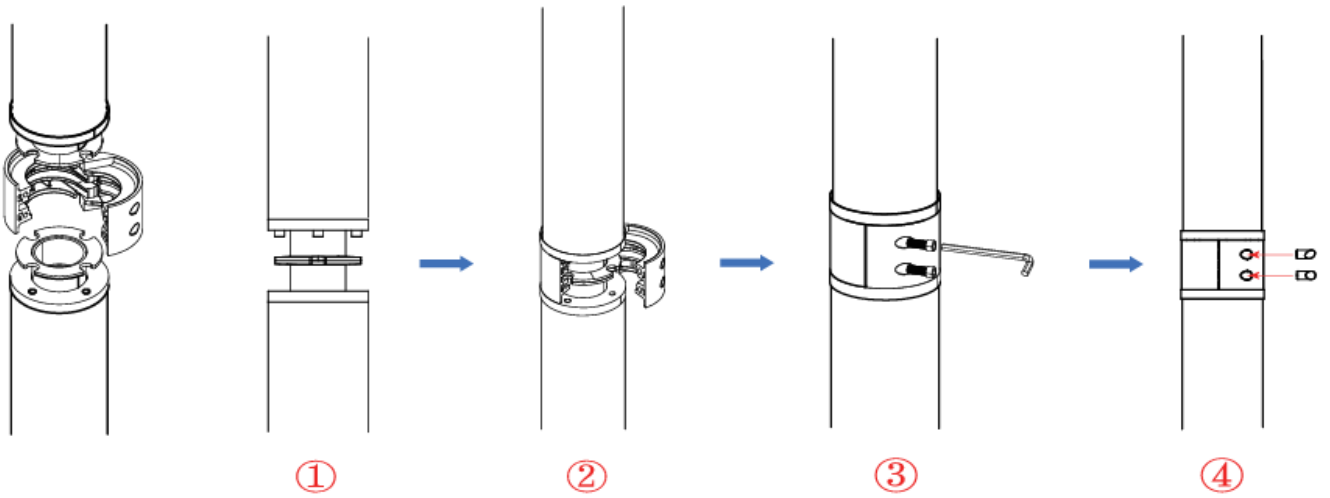

Step 1: Align and tighten the fixings of the two modules.

Step 2: Clamp with movable connector.

Step 3: Lock the screws to fix.

Step 4: Insert the decorative silicone plug.

Fixing between splicing pole and lamps/electrical appliances

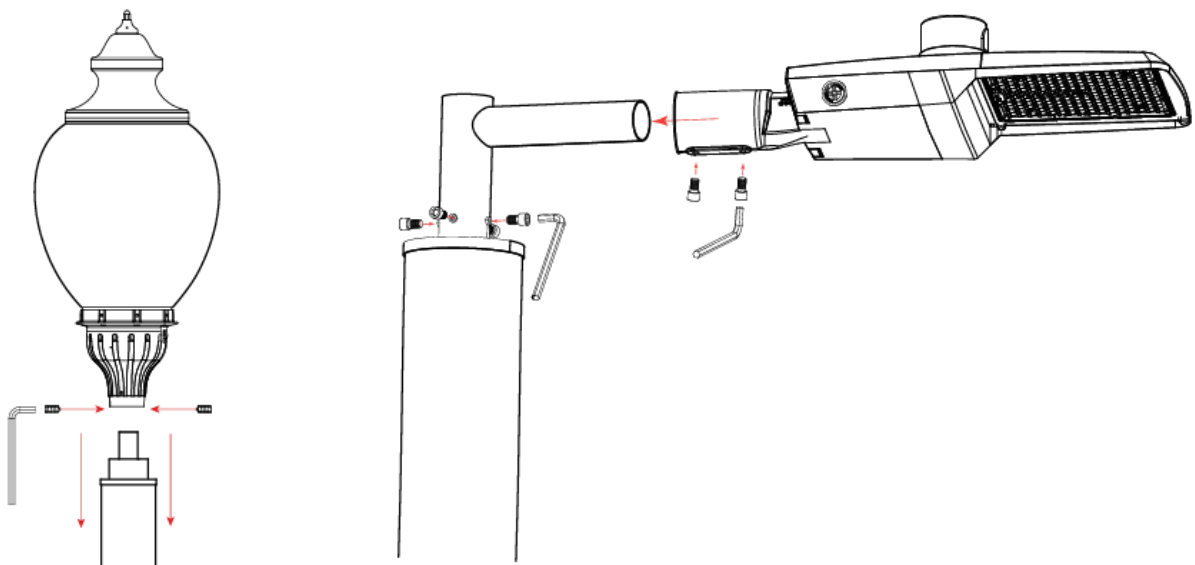

Put the lamp base over the top adapter of the solar light pole and tighten it with screws.



REMOTE & INDICATOR INSTRUCTIONS

Remote Control Guide

Different modes can be selected according to actual conditions

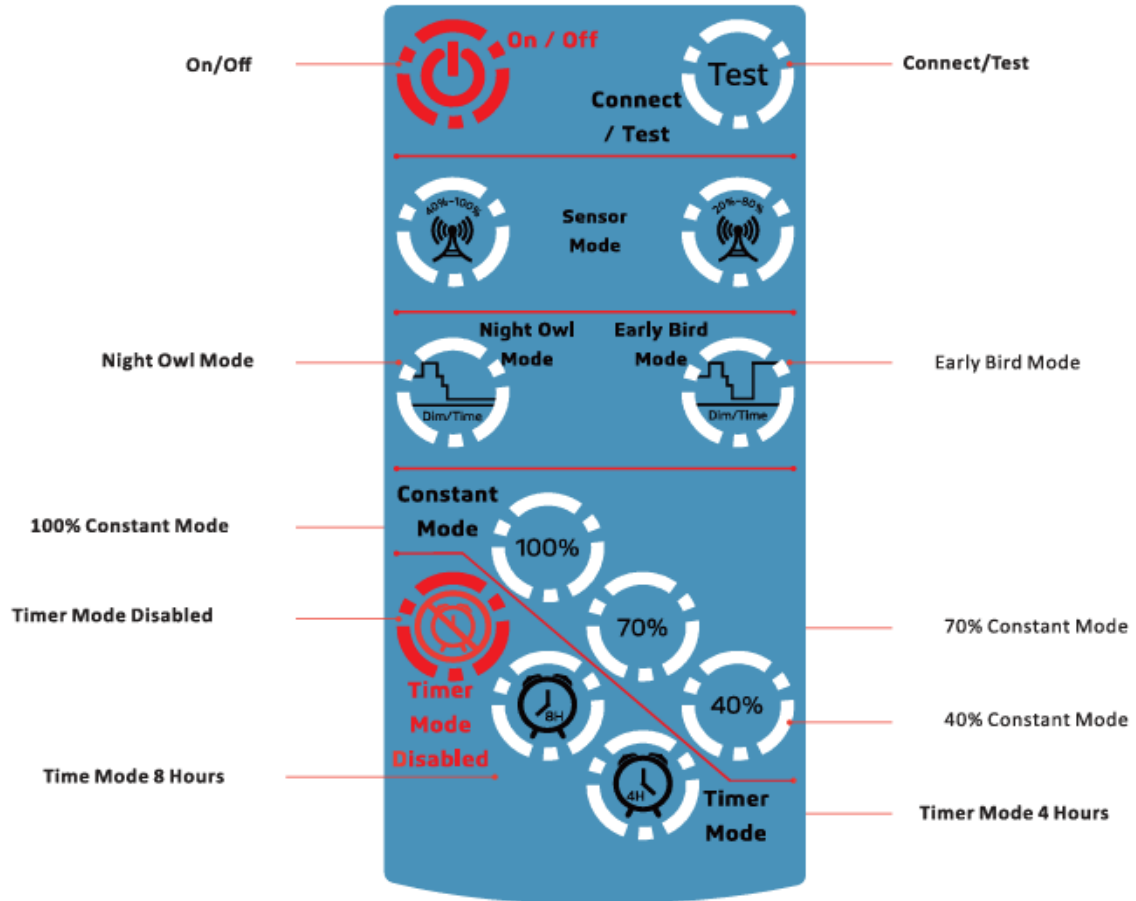

*For detailed description of each mode, please refer to the product installation manual.

Indicator description

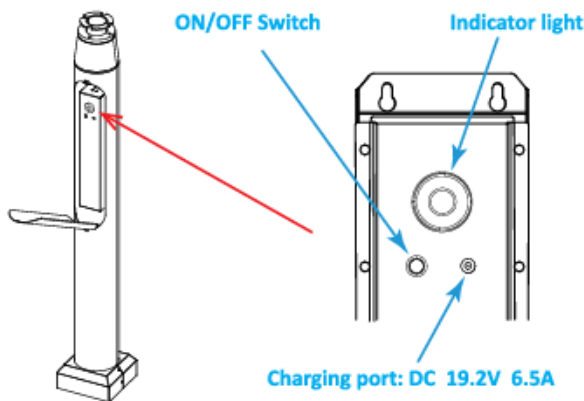

Normal Outdoor Operation:

1. The light has been charged and ready to work
(Stand by Mode): Solid red indicator
2. The battery has less than 10% charge: Green indicator flashes
3. The light is on (Working Mode): Solid green indicator
4. Switch to on-grid power: Solid blue indicator (Optional)
5. The battery is charging (Stand by Mode): Red indicator flashes



PACKAGING

MODEL	MASTER CARTON(L*W*H)	Q'TY/CTN(PCS)	GROSS WIGHT(KGS)	CUBIC METER
Pole Base	2124*345*347mm (83.62"*13.58"*13.66")	1	41.4	0.25m ³ (8.83ft ³)
Pole/panel section	1307*287*268mm (51.46"*11.30"*10.55")	1	16.8	0.10m ³ (3.55ft ³)
Battery Component	782*223*210mm (30.78"*8.78"*8.27")	1	13/15/17	0.04m ³ (1.29ft ³)

POLE BASE

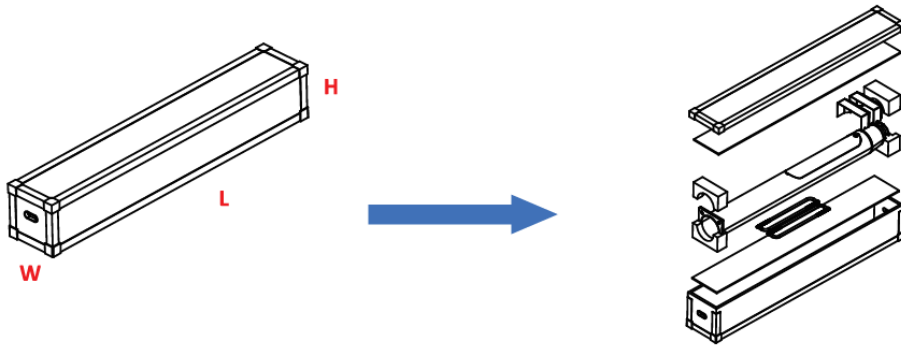

POLE/PANEL SECTION

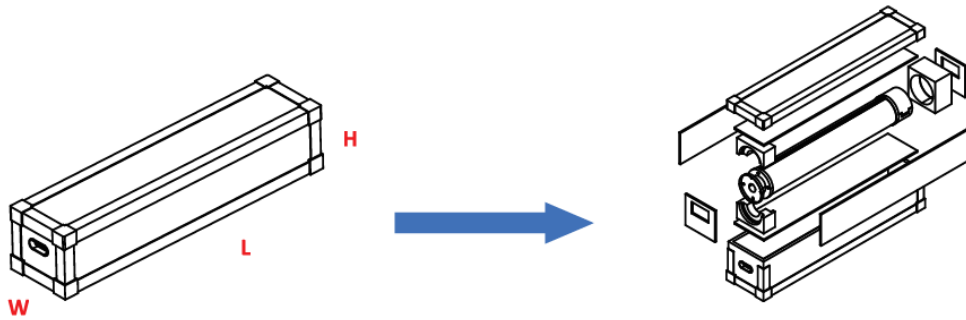

BATTERY COMPONENT

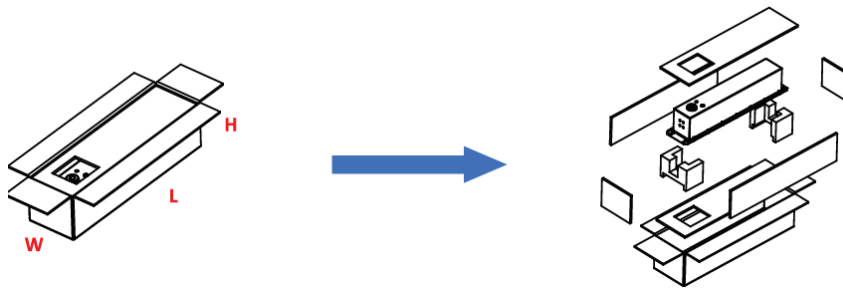

PRODUCT WARNINGS

- ⚡ Please turn off power before install or change assembly parts.
- ⚡ The input voltage and lamps should be matched, after connecting the power line.
- ⚡ Please make sure the wiring section is insulated.
- ⚡ Professionals must install and disassemble the lamps.
- ⚡ Surge is the number 1 cause of LED light failure. Outdoor lights must have surge at fixture, pole, and breaker.
- ⚡ Surge is the number 1 cause of LED light failure. Indoor lights must have surge at fixture and breaker.

PRODUCT TROUBLESHOOTING

Issue	Check points
Light Flickers	Check all wiring for disconnections, shorts and burnt wiring and connections. Confirm steady input voltage to the light fixture, fluctuating input voltage will harm the LED driver and can lead to premature failure. Lights with photocells can have photocell tag from ambient light or light reflecting at the sensor. Simply cover the photocell completely and see if flickering continues while the photocell is covered. Call Tech Support for help if none of the above solves the issue.
Light does not work at all.	Check all wiring for disconnections, shorts and burnt wiring and connections. Confirm steady input voltage to the light fixture, fluctuating input voltage will harm the LED driver and can lead to premature failure. If input voltage is not in the voltage range of the fixture, you will need to find the source of your input voltage issue. Call Tech Support for help if none of the above solves the issue.

For more technical information, install questions, troubleshooting help or warranty claims, we have a dedicated US Tech and Customer Support Team to help solve any issues you have and can be reached by email or phone. If you need help with any of our products, we are here for you so that you are never in the dark!



**BETTER LIGHTS.
BETTER SUPPORT.**



CERTIFIED



LISTED



LEGENDARY RUGGEDGRADE DUTY
LEGENDARY USA SUPPORT



US based
phone and online
customer support



ROCK SOLID
5 YEARS
WARRANTY