

## PRODUCT DESCRIPTION

THE NSF VAPOR LIGHT BRINGS YOU THE PINACLE IN FOOD SAFETY LIGHTING. IT LETS YOU LIGHT UP ANYTHING FROM SIMPLE FRUITS AND VEGETABLES ALL THE WAY UP TO PRIME CUT MEATS AND MORE. ITS PERFECT FOR SUPERMARKETS AND EVEN FOOD PROCESSING SPACES.



PART #: NSF-165W-TT

## PRODUCT FEATURES & COMMON USE APPLICATIONS

- ✓ UL cUL
- ✓ Input voltage 120-277Vac
- ✓ No UV or IR in the beam
- ✓ Easy to install and operate
- ✓ Energy saving, long lifespan
- ✓ Instant start, NO flickering, NO humming
- ✓ Green and eco-friendly without mercury
- ✓ 5 Year Warranty.

- ✓ Food Processing Spaces
- ✓ Pharmaceutical Factory
- ✓ Farm
- ✓ Car wash
- ✓ Super Market

## PRODUCT DIMENSIONS

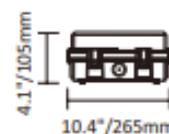
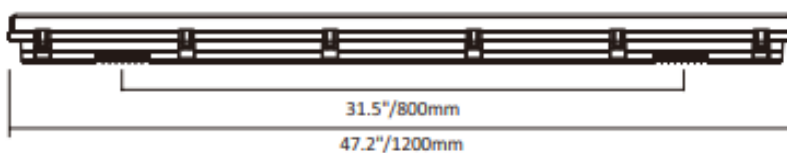

RATED EXCELLENT ★★★★★ ★ Trustpilot

## PRODUCT TECHNICAL SPECIFICATIONS

OPTICAL	Input Power (Tolerance: ±10%)	165W/135W/105W(Wattage Selectable)		
	Color Temperature	3500K	4000K	5000K
	Lumen (Tolerance: -10%)	24750 LM	27400 LM	25350 LM
	Efficacy (Tolerance: -3%)	150 LM/W	166 LM/W	154 LM/W
	CRI	>80		
	Distribution Pattern	NA		
	Beam Angle (50%) (Tolerance: ±15%)	120°		
	Input Voltage and Frequency	120-277VAC, 50/60Hz		
ELECTRICAL	PF (Tolerance: -3%)	≥0.9		
	THD (Tolerance: +5%)	≤20%		
	Flicker Percent	<5%		
	Driver Brand	RG Driver		
	Driver Model	RG-165W-120V		
	Driver Surge protection	L/N-PE: 10kV, L-N:10kV		
	Dimming	No		
	Optional Accessory	None		
MATERIALS	LED Brand	Lumileds		
	LED Type	SMD2835		
	LED QTY	288 PCS		
	Housing	PC+aluminum		
	Housing Color	White		
	EPA	Call for more info		
	Waterproof Rating	WET (IP65)		
OTHERS	Operating Temperature	-40°C TO 45°C		
	Storage Temperature	-40°C TO 80°C		
	Operating Humidity	20% - 70% RH		
	Storage Humidity	10% - 75% RH		
	Warranty	5 years warranty with 24/7 operating hours Luminaire lifetime at 25°C.		

## PRODUCT MOUNTS & ACCESSORIES



**XEBB017-15WDC**  
Emergency Battery Backup  
EMB15YY-260 -15W/90min,  
for X-VTW, at AC120-277V/347V



Suspended mounting kit

## PRODUCT IMAGES & ACTUAL INSTALLATIONS

**ALWAYS TURN OFF THE POWER SUPPLY FROM MAIN CIRCUIT BREAKER FIRST!**

### Installation mode 1 Surface Mount

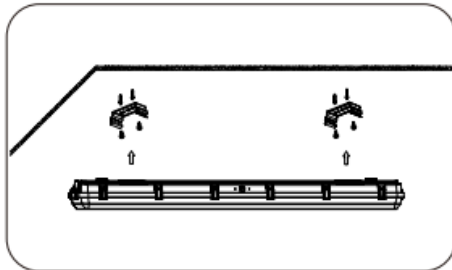

1. Secure mounting clips to ceiling using 4-8 screws. Space the clips 33.67 inches apart for 4 foot luminaire, or 37.8 inches apart for 8 foot luminaire. Orient the luminaire so conduit fitting faces incoming supply power or conduit. Align the recesses and apply gentle upward pressure to secure luminaire onto both mounting clips.

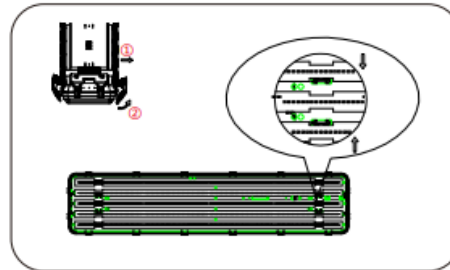

2. Release latches by pulling top of latch away from housing. Gently squeeze the buckle in and take out the PCB board (be careful not to touch the LEDs).

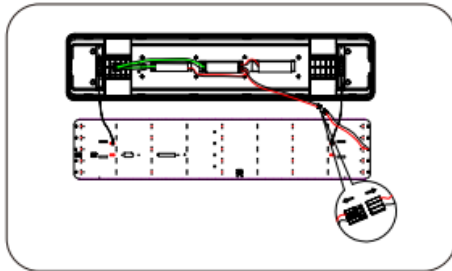

3. Disconnect the wire connecting the LED board and the driver to avoid unstable connection due to heavy suspension.

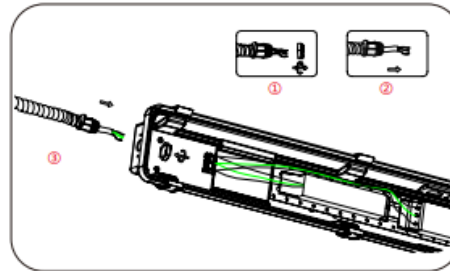

4. Separate the waterproof plug, and connect the input wire to the output wire of the power supply after passing through the plug and the outlet as shown in the figure.

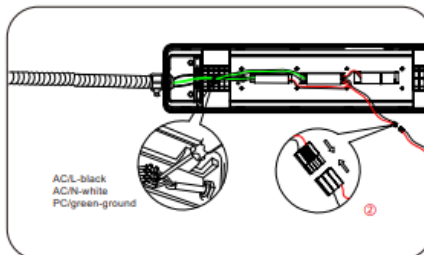

5. After the connection is completed, tighten the waterproof plug. Reconnect the wiring between the LED board and the driver.

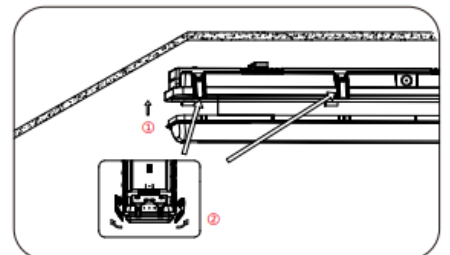

6. After align lens and bottom housing, turn off the luminaire. Secure lens to housing with lens latches.

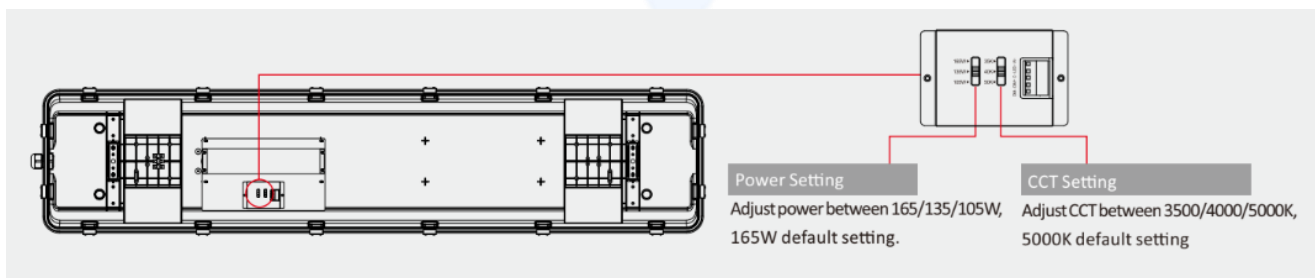

## PRODUCT IMAGES & ACTUAL INSTALLATIONS

### Installation mode 2 Suspension Mount

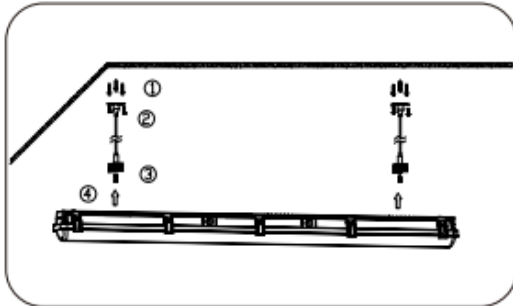

1. Secure suspended mounting kits to ceiling using 6-12 screws. Secure another side of suspended mounting kits to clips using 4-8 screws. Orient the luminaire so conduit fitting faces incoming supply power or conduit. Align the recesses and apply gentle upward pressure to secure luminaire onto both mounting clips.

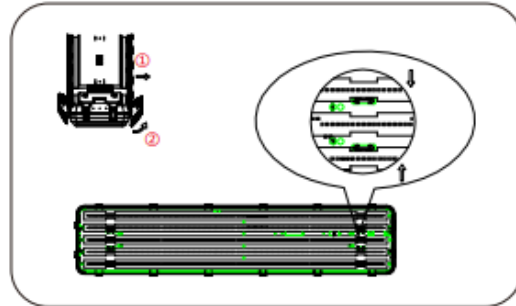

2. Release latches by pulling top of latch away from housing. Gently squeeze the buckle in and take out the PCB board (be careful not to touch the LEDs)..

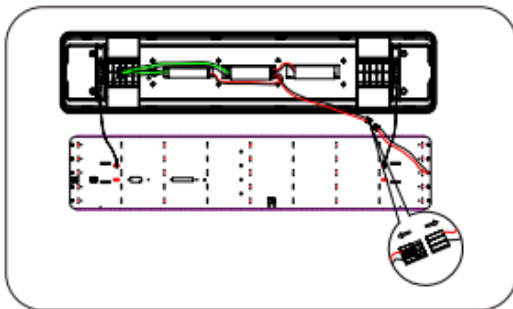

3. Disconnect the wire connecting the LED board and the driver to avoid unstable connection due to heavy suspension.

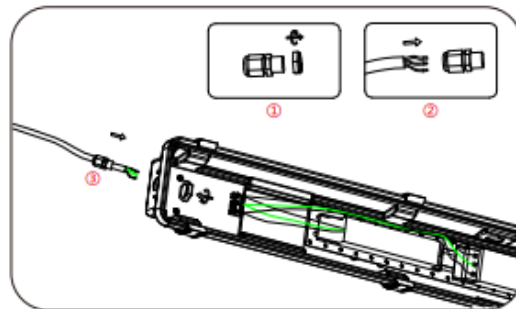

4. Separate the waterproof plug, and connect the input wire to the output wire of the power supply after passing through the plug and the outlet as shown in the figure.

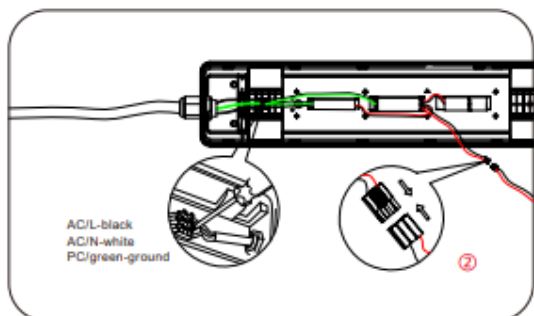

5. After the connection is completed, tighten the waterproof plug. Reconnect the wiring between the LED board and the driver.

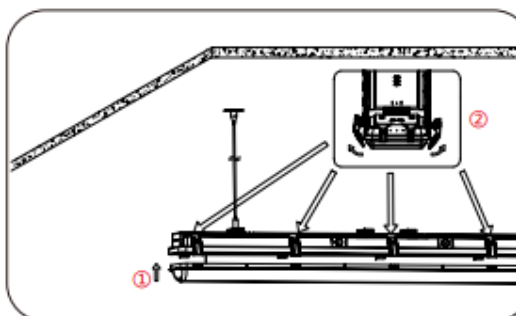

6. After align lens and bottom housing, turn off the luminaire. Secure lens to housing with lens latches.

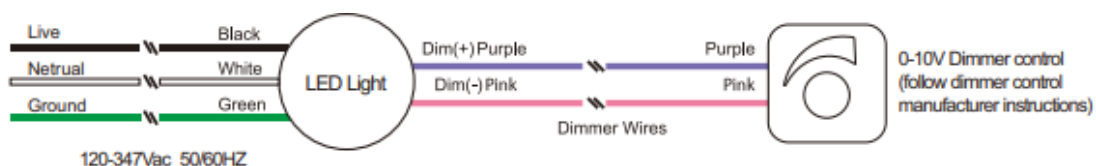

## PRODUCT WARNINGS

- Please turn off power before install or change assembly parts.
- The input voltage and lamps should be matched, after connecting the power line.
- Please make sure the wiring section is insulated.
- Professionals must install and disassemble the lamps.
- Surge is the number 1 cause of LED light failure. Outdoor lights must have surge at fixture, pole, and breaker.
- Surge is the number 1 cause of LED light failure. Indoor lights must have surge at fixture and breaker.

## PRODUCT TROUBLESHOOTING

Issue	Check points
Light Flickers	Check all wiring for disconnections, shorts and burnt wiring and connections. Confirm steady input voltage to the light fixture, fluctuating input voltage will harm the LED driver and can lead to premature failure. Lights with photocells can have photocell tag from ambient light or light reflecting at the sensor. Simply cover the photocell completely and see if flickering continues while the photocell is covered. Call Tech Support for help if none of the above solves the issue.
Light does not work at all.	Check all wiring for disconnections, shorts and burnt wiring and connections. Confirm steady input voltage to the light fixture, fluctuating input voltage will harm the LED driver and can lead to premature failure. If input voltage is not in the voltage range of the fixture, you will need to find the source of your input voltage issue. Call Tech Support for help if none of the above solves the issue.

For more technical information, install questions, troubleshooting help or warranty claims, we have a dedicated US Tech and Customer Support Team to help solve any issues you have and can be reached by email or phone. If you need help with any of our products, we are here for you so that you are never in the dark!



RATED EXCELLENT  ★ Trustpilot